



Matterport Pro3 Quick Start Guide

May 2025
Version 1.0

Produced by Apartments.com
A CoStar Group Company

Scan this QR code to
access a web version
of this guide.



CONTENTS

Setup	4
Set up the Tripod	4
Attach the Tripod Mount	4
Unbox the Pro3	5
Install the Battery	6
Mount the Pro3	7
Power Up	8
Get Connected	9
Get the App	9
Confirm Camera Readiness	9
Enable Bluetooth	10
Open the Matterport App	10
Check Connection	10
Camera Display Guide	11
Capture + Utilize Tours	12

Matterport Pro3 SETUP

Congratulations on receiving your new Matterport Pro3!

This guide is designed to help you get your Pro3 camera set up quickly and easily, so you can begin capturing immersive, professional-grade 3D tours in minutes. Let's get started!

1

Set up the Tripod

Adjust the height to 4.5 feet (1.37 meters).

2

Attach the Tripod Mount

Screw it tightly onto the center column of the tripod base.

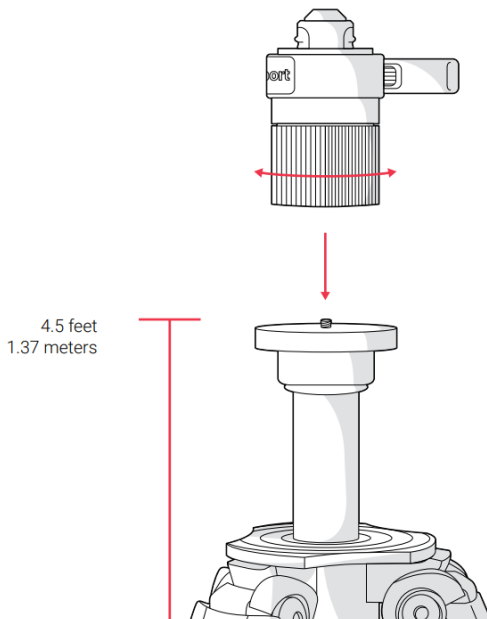

3

Unbox the Pro3

Gently pull the red tab, and lift from the bottom of the camera.

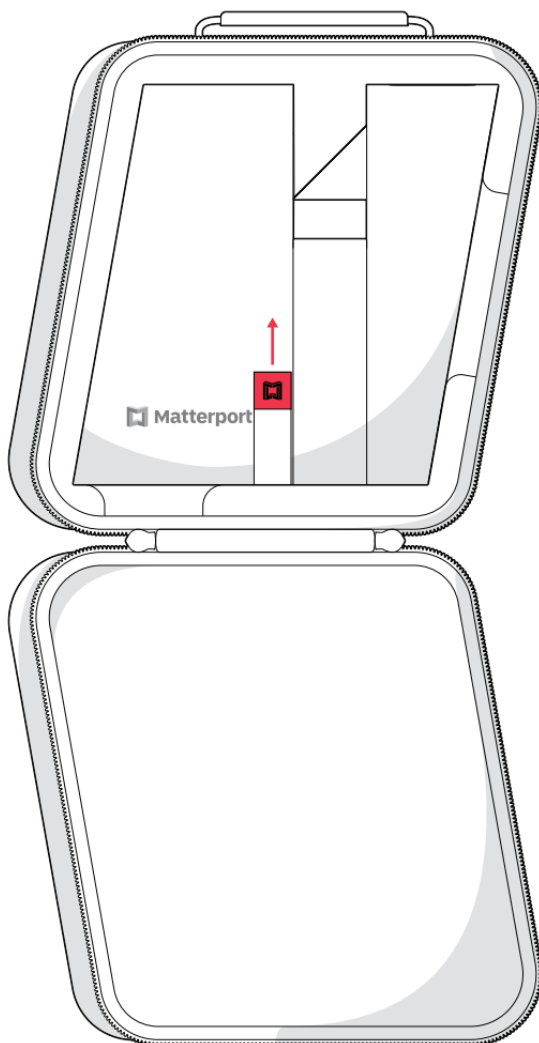

4

Install the Battery

Place the camera on its side on a flat surface. Align the pins on the battery with the pins within the battery compartment and snap into place. You should not have to force the battery, so if you feel like you need to use a lot of force, stop and ensure the pins are aligned correctly.

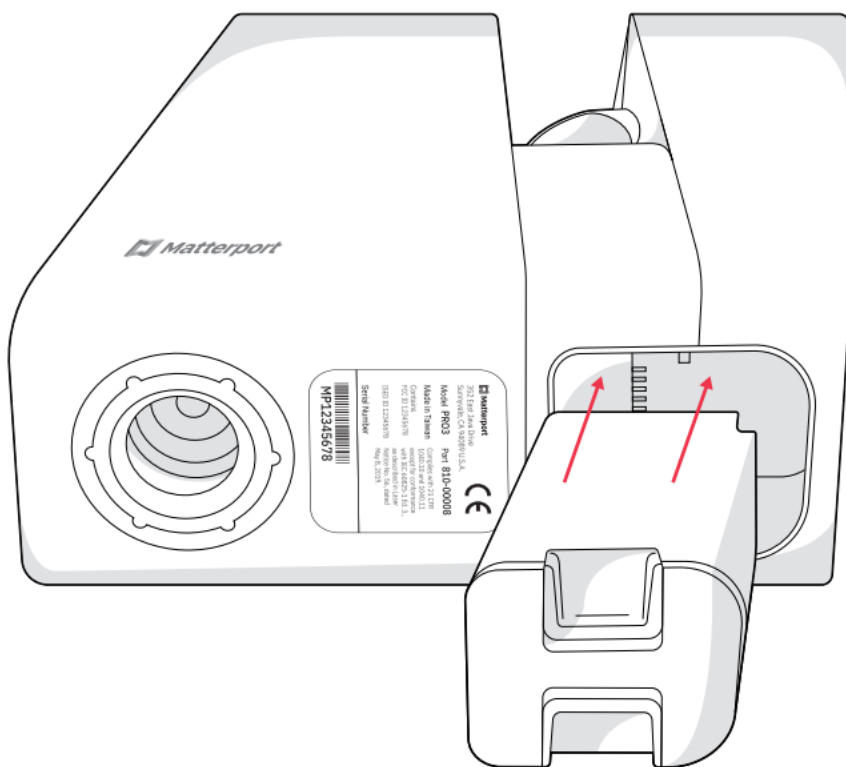

5

Mount the Pro3

Important: Keep the camera level and aligned as you lower it into place to prevent breaking the tripod mount.

Open the clamp on the side of the tripod mount. Align the tripod mount socket on the bottom of the camera with the top of the tripod column, and lower the camera into place with both hands. Keep one hand on the top of the camera to hold it steady as you close the clamp to secure it.

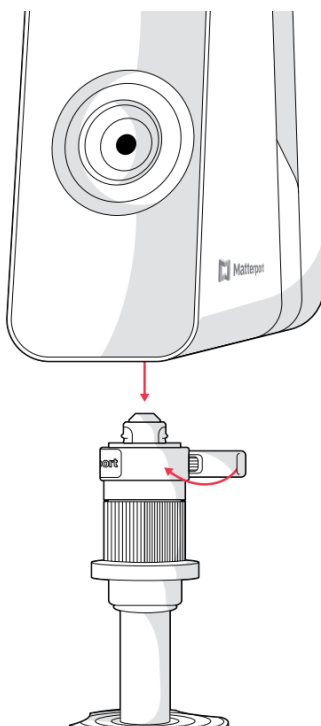

Note: The camera's rotational axis is aligned with the lens, not the center of the camera. This profile is stable and secure when properly mounted as detailed above.

6

Power Up

Press and hold the power button (~2 seconds) on the rear panel of the camera, beneath the display screen. Remove the magnetic lens cap.

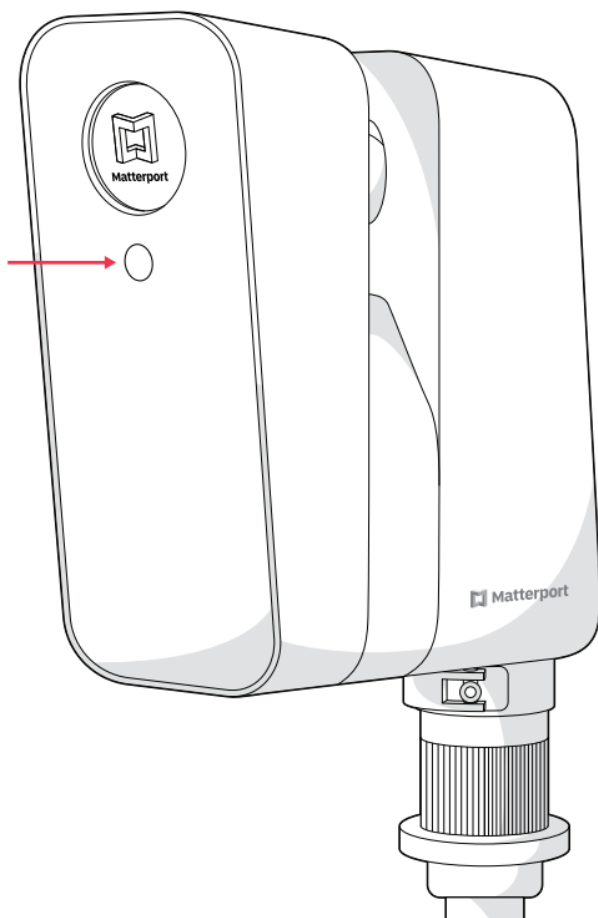

Note: The Camera Display shows the Matterport logo to indicate that it's booting and warming up.



Matterport Pro3

GET CONNECTED

1

Get the App

Download the Matterport app for your iOS or Android device to start using Pro3.



2

Confirm Camera Readiness

After the camera is done booting, the Ready to Pair icon (pictured below) will appear on the camera display.



3

Enable Bluetooth

Verify that Bluetooth is turned on within your device settings and that the Matterport app has permission to use it.

4

Open the Matterport App

Open an existing job or start a new one by tapping the **+New Job** button. Then tap the **source selector** button and select **Matterport Pro3** to connect to your camera.

5

Check Connection

When your camera and device are connected, the **Connected** icon will appear (and time out to the **Ready to Scan** icon) on the display screen of your Pro3. Additionally, Matterport Pro3 will appear above the camera button within the app.

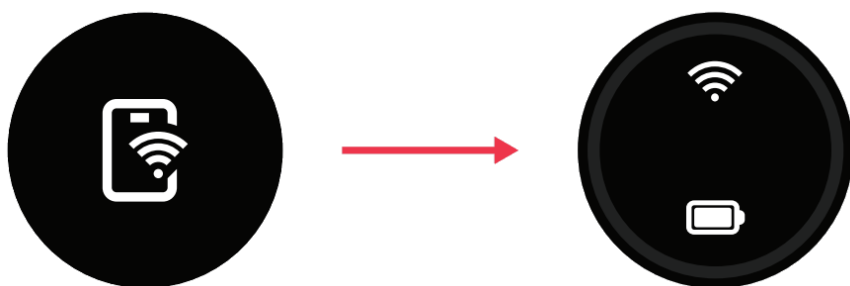

Camera Display Guide

Connected

Indicates the camera is connected to Wi-Fi.



Ready to Scan

Indicates the camera is ready for rapid scanning from point to point.



Scanning

Green line indicates scan progress as the camera rotates.



Ready to Move

Once a scan is complete, this indicates the camera is ready to move to the next scan point.



Error Status

Check the Matterport app or visit go.mp/pro3 to look up the error code on the screen.



Battery Status

When the camera is off, tap the power button to check the battery level without booting up the camera.



Matterport Pro3

CAPTURE + UTILIZE TOURS

Now that you're connected its time to create your first 3D tour!

Scan the QR code below to access our Help Center article on creating and uploading a Matterport 3D Tour to your Apartments.com listing.

Scan this QR code to
access our Help Center.



